



MAYOR'S BOUQUET



This month's bouquet recipients are Sally and Alistair Papps, for their voluntary work and dedication to Isel House over the past 16 years.

Having formed the Isel House Charitable Trust, the Papps have quite literally been the guardians to one of Nelson's most treasured historic homes.

Over the years, they have given up their time to ensure the House runs smoothly, managing the day-to-day operations, and spending nearly every summer weekend at Isel front of house, ensuring the doors are kept open for the public.

It is an understatement to say the Papps have breathed new life into the House, they have restored and refurbished this protected heritage house, and ensured its significant cultural and heritage values are shared with visitors and locals.

It is a pleasure to be able to publicly recognise Sally and Alistair for their invaluable contribution.



2
Coastal pepper tree needs a helping hand



3
Your guide to this year's Light Nelson experience



7
Trafalgar Centre progress update

Light Nelson to brighten up winter



Photo © Elizabeth Clarkson

Light Nelson, the city's winter light festival, is bigger and brighter than even the organisers expected.

It's the third time Nelson has produced the community focussed, free festival of light, and Light Nelson Trust Chair Brian Riley says the organisers are amazed at the event's growth.

"We set out this year with 40 installations, and that number has now grown to 60 – I'm really amazed at how much the community is on board," he says.

"There are sewing sessions where people are helping the Kayan community stitch lights into their ceremonial banners, the 80-strong Boathouse Choir is learning songs to back the Māori creation story, told by Nelson Intermediate students, children are painting day-glow endangered birds for the Brook Sanctuary's Nocturnal, Waimea College kids are learning about physics with their Luminoscillator, and we have illuminated papier mache puppets being made by Community Art Works."

Mayor Rachel Reese says Light Nelson gives us an excellent reason to embrace winter time in Nelson.

"Council is very proud to be a key supporter of this hugely popular event. I believe Light Nelson has the potential to provide that 'winter Christmas' influx of visitors that our retailers and hospitality sectors love to see. It is about making Nelson an all-year-round destination," she says.

"It's also about positioning this city exactly as we want to portray ourselves – creative with a strong sense of community. I am confident this year will be bigger and better and I look forward to seeing you all around town enjoying this wonderful experience. It can only continue to grow year by year."

Riley says he was confident the event would be a great experience for everyone this year.

"We have increased the number of nights we're on, we are making more use of the NMIT campus as well as the Queens Gardens, we're closing off part of Hardy Street and will have a hub there with food stalls."

Riley paid tribute to the sponsors and individuals who have helped to maintain Light Nelson as a free event, particularly to this year's boost in funding from Nelson City Council.

"The essence of Light Nelson is that it is art for everyone so it's really a must to keep it free," he says.

Light Nelson, 8–12 July, Queens Gardens, NMIT and surrounds, 5.30–9.30pm.

Inside this issue of Live Nelson you'll find all the information you need to help you make the most of this year's Light Nelson experience. See you there!

 Check out our website
nelson.govt.nz

 Phone us on
03 546 0200

 Follow us on Twitter
twitter.com/nelsoncitynz

 Have your say on Facebook
facebook.com/nelsoncitycouncil

 Watch us on YouTube
youtube.com/nelsoncouncil

To sign up for electronic Live Nelson go to:

 facebook.com/nelsoncitycouncil

Waimea Road detour starts 11 July

Starting from 7am Monday 11 July, for up to eight weeks, the southbound (out of town) lane of Waimea Road will be closed and detoured via Rutherford Street and Van Diemen Street.

Northbound (in to town) traffic will not be changed, except for when Waimea Road will need to be fully closed for two nights only during this time. In this case, northbound traffic will also detour via Van Diemen Street and Rutherford Street, for those short periods.

Van Diemen Street will be closed at the Ngatitama Street intersection to allow southbound traffic to keep moving.

- Eastbound traffic on Van Diemen Street will detour via Rutherford Street.
- Westbound traffic on Van Diemen Street will detour via Ngatitama Street.

- There will be no traffic flow between Rutherford Street and Ngatitama Street.

This detour is for the construction of an underground stormwater chamber in Waimea Road.

Access for residents and businesses will still be available. The Challenge service station will stay open for business as usual with access from Van Diemen Street.

Parking will be temporarily restricted in the following locations:

- Parking on Rutherford Street from Van Diemen Street to about 50m north of Van Diemen Street will be stopped.
- Angle parks on Van Diemen Street adjacent to Hampden Street School will be converted into a parallel parking student drop off / pick up zone.
- Some parking on Hampden Street between Ngatitama Street and Waimea Road will be stopped.
- Some parking on Ngatitama Street will be stopped.

Please allow extra time for your journey or choose another route if possible.

If you are able to cycle or take the NBus instead, you will help to reduce congestion on the road.

We realise this detour will be inconvenient for residents and road users alike. However it is essential to complete the crucial Little Go Stream stormwater upgrade, with the aim of preventing future damage in heavy rain events. Thanks for your patience and understanding during this time.



Coastal peppergrass is a nationally critical plant that is only found in Tasman Bay.

Coastal peppergrass needs a helping hand

You can help a critically endangered species make its way back from the brink of extinction.

Coastal peppergrass, which only grows in the wild in parts of Tasman Bay, has the highest threat ranking of "nationally critical" because there are so few plants surviving in the wild.

The Department of Conservation (DOC) has found that the best survival chance for this plant is by using the seed gathered from mature plants to establish coastal peppergrass at new sites. If you'd like to help with this effort, you can get involved by growing peppergrass in your garden and harvesting the seed for use by DOC.

If you'd like to help this conservation effort, call in at the Nelson i-SITE to collect a packet of seed with seed raising and plant care instructions. You'll be asked to leave your contact details so that a DOC ranger can contact you later in the year to arrange to collect harvested seed.

Council lifts moratorium on inner city outdoor dining

Council has voted to lift its outdoor dining moratorium in the central business district, allowing eateries to apply for licences to use public car parking spaces for outdoor dining.

The moratorium on exclusive use of public car parking spaces for commercial activity was introduced in 2003, to ensure parking needs were met in the inner city.

With 82% car parking occupancy identified as part of a survey in 2015, Council decided there was room to lift the restrictions on outdoor dining, adding to 13 active licences for outdoor dining, currently occupying 21 public car parking spaces.

Mayor Rachel Reese says this is something that she has been aiming to achieve for a long time.

"This is about creating a vibrant, people-

friendly CBD, which is a goal of Council, and I am committed to ensuring we are achieving our goals as a city," she says.

"In receiving applications for additional outdoor dining spaces, Council will balance the needs of inner city businesses, with the need for car parking.

"I am confident that this is a step in the right direction and will further develop our inner city into a thriving place to visit."

In addition to lifting the moratorium, Council requested officers investigate the feasibility of the licensed outdoor dining areas being smokefree.





Light Nelson

8-12
JULY
2016

NIGHTLY, 5.30-9.30PM



INTRODUCING LIGHT NELSON

Light Nelson is here to brighten up the winter with an outdoor gallery of brilliant light installations, clustered around the lawns, pond and massive trees of our historic Queens Gardens, and extending into the campus of NMIT.



From the spark of an idea back in 2013, Light Nelson has captured the imagination of artists, the people of Nelson and of visitors who love to enjoy our region's creativity.

This year, in a collaboration of art, science and technology, over 50 artists let their creativity loose via innovative media such as laser technology, digital imagery, performance, music and shadow-puppetry. Don't miss the special works from our guest artists, Daniel Belton and Jon Baxter; and the retro electronica of NEON in Old St John's.

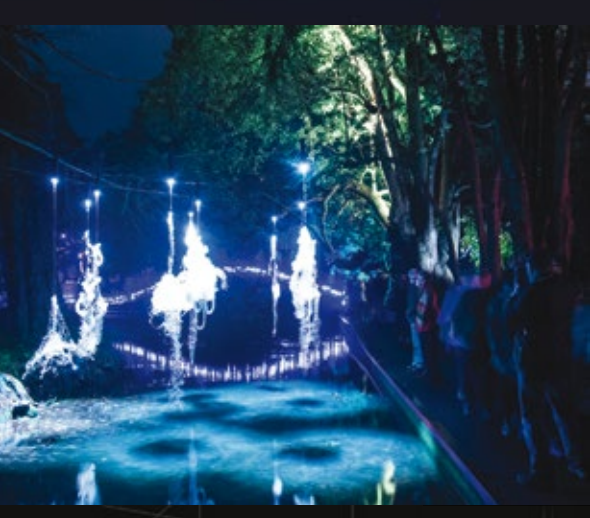

Light Nelson is an irresistible mix: a garden walk in the clear dark night of winter with magic moments of illusion, beauty, interaction and fun. With the support of our sponsors and the Nelson City Council we are thrilled to offer you this experience at no charge.



Enjoy Light Nelson, tell your friends, join us on Facebook and come back in 2018.

MESSAGE FROM NELSON CITY COUNCIL

Council is proud to support the hugely popular Light Nelson. Events like this bring tangible economic benefits to our region, as well as the obvious social and cultural rewards. While already a favourite summer hot spot, growing our annual calendar of events goes a long way to developing Nelson as a desirable, year-round destination. Council is always looking for opportunities to encourage people to visit and Light Nelson helps to grow our visitor market and strongly position Nelson as a creative, innovative city. Of course, Light Nelson also offers the chance for locals to experience their city in a new, exciting way. We look forward to another exciting programme this year, and to working together to make Nelson an even better place for both locals and visitors alike.

Nelson City Council

WELCOME FROM THE LIGHT NELSON TRUST

Welcome to Light Nelson 2016. To say this event is community focused is an understatement. Behind each of our installations stands a creative team – artists, electricians, technicians and other supporters. Then there is the huge financial support from our wonderful sponsors, the marvellous Luminaries, and once again this year, the Nelson City Council. All helping to keep Light Nelson free and accessible to all. Last but not least – you! All this effort goes into creating a community event for us all to enjoy. Thank you for coming – now let the fun begin!

Brian Riley
Chair Light Nelson Trust

INSTALLATIONS

MORE INFORMATION ON ALL PROJECTS AT LIGHTNELSON.ORG.NZ

01 NEON IN OLD ST JOHN'S
NEON

02 SANDCASTLE MUSIC
PETER SQUIRE

03 FIRE AND ICE
BRIGHT SPARKS ENTERTAINMENT

04 LUMINOUS BOXES
KLAASZ BREUKEL

05 RUSALKA
ALISON ABERNETHY

06 THE STORY
JOHN-PAUL POCHIN

07 BRING TO LIGHT
YAËL DEER & PROJECT BUTTERFLY

08 KERERŪ
GOLDFISH CREATIVE

09 WOW LIGHTBULB MEN
WE LOVE DONATIONS!

10 THE TREE OF LIFE
FRANCIE SILVA

11 CELEBRATION
VINNY ARORA & JENNY FLEMING

12 AMELIA
CELINE RAATS

13 NOCTURNAL
LORI DAVIS & LARISSE HALL

14 TURTLE NET
JASMIN SIXTUS

15 LUNAR LANDER
JOHN-PAUL POCHIN

16 SYNTHETIC NATURE
RACHAEL PERSICO, BETHAN FLETCHER
& CHELSEA CAMERON

17 THEATRE OF LIGHT
DANIEL BELTON & GOOD COMPANY
SUPPORTED BY STRAWBERRY SOUND

18 LUMINOSCILLATOR
WAIMEA COLLEGE & DREW MCGLASHEN

**19 MISSION IN SEARCH OF TANGIBLE
REACTIVE ALIEN LIFE**
FRITZ KUCKUCK & MARIA GRAU

20 MAKING A SPLASH
DEAN HAYTON & SARAH ARNOLD

21 HOW THE KIWI LOST ITS WINGS
COMMUNITY ART WORKS

22 THE HONEY POST
ADRIAN TUCKWELL

23 SHADOW RABBIT
CATHARINE SALMON & BERNARD GOETZ

24 SHADOW WORLD
ARTS & MEDIA LEVEL 5

25 CONTEMPORARY REIDENTITY
ARTS & MEDIA LEVEL 4

26 THE CATCHER OF DREAMS
SUE HARDING

27 FROM THE INSIDE OUT
FLORENCE BERTHOLD

28 TREE OF KNOWLEDGE
LENNY WILLS

29 DA BIRDHOUSE
COLUMBA GENUS

30 WELCOME TO OUR REALITY
BRITTANY WHITTNAL, ROCHELLE CRAIG
& LAUREN CHADDERTON

31 CHILD'S PLAY
PAIGE CLIMO & KAYLA BOVEY

32 NOWHERE TO HIDE
STEPHANIE PARKIN

33 LANGUAGE IN OUR HANDS
LOUISA HOPCROFT

34 CELESTIAL SKIES
CAITLIN HAYWARD

35 FLORA AND FAUNA
JASMINE DAVIES

36 MEDUSOZOA
RIKKI-LEE HANNAH & ALIYA EGAN

37 ROCKY ROAD
JOHN-PAUL POCHIN

38 THE LOVER AND THE LOOKOUT
SHADES ARCADE

39 ONEONE
DANIEL BELTON & GOOD COMPANY
SUPPORTED BY STRAWBERRY SOUND

40 UNLESS
SUSAN FRANCIS & MARK BROAD

41 THRESHOLD
ANNA MCMEEKEN

42 A TRIP INTO THE NATURE OF BEING
JON BAXTER - PERCEPTUAL ENGINEERING

43 A LIGHT CONVERSATION BETWEEN BODIES
MATTHEW MARTIN & JENNA GAVIN

44 SHAPEDSHIFT
ELPARO

45 CAMPLIGHT
JOHN-PAUL POCHIN, DR KAY SNEDDON,
LOCAL KAYAN WEAVERS

46 BAMBOOZLE
CHRISTOPHER VINE

**47 IT DON'T MEAN A THING IF IT AIN'T
GOT THAT SWING**
HAZEL & FROG TWISSELL

48 REFLECTING ON CIRCULAR MOTION
KILMENY STEPHENS

49 BALLS OF FIRE
ANTHONY GENET

50 MOTHER DAUGHTER REEF
LYNDA DUNCAN, ELLA DUNCAN
& SUE GARLICK

51 PADDLE BOAT
JAMIE FOSTER

52 AQUATIC EXPRESSIONS
KLAASZ BREUKEL

53 LUMINOUS DANCE
ANNE RUSH

54 BRIDGE TO HEAVEN
IAN MORTIMER OF MIYAZU SISTER CITY

55 RAINBOW TO SOURCE
BEN CLEGG

56 BUNDLE
ANTHONY GENET

57 THE INTERACTIVE EARTH
JON BAXTER - PERCEPTUAL ENGINEERING

58 FLOODLIGHT
K+K

59 NIGHT FISHING
NZIA NELSON ARCHITECTS

60 RESURRECTION
FLEUR STEWART

61 SCALES OF SUNLIGHT
GOLDFISH CREATIVE

62 COMRADE SHIP
RANGIWAHIA ENVIRONMENTAL
ARTS CENTRE

PLEASE NOTE:
INSTALLATIONS 24 TO 36 ARE ALL
LOCATED INSIDE NMIT'S G-BLOCK
(THE ARTS & MEDIA BUILDING)

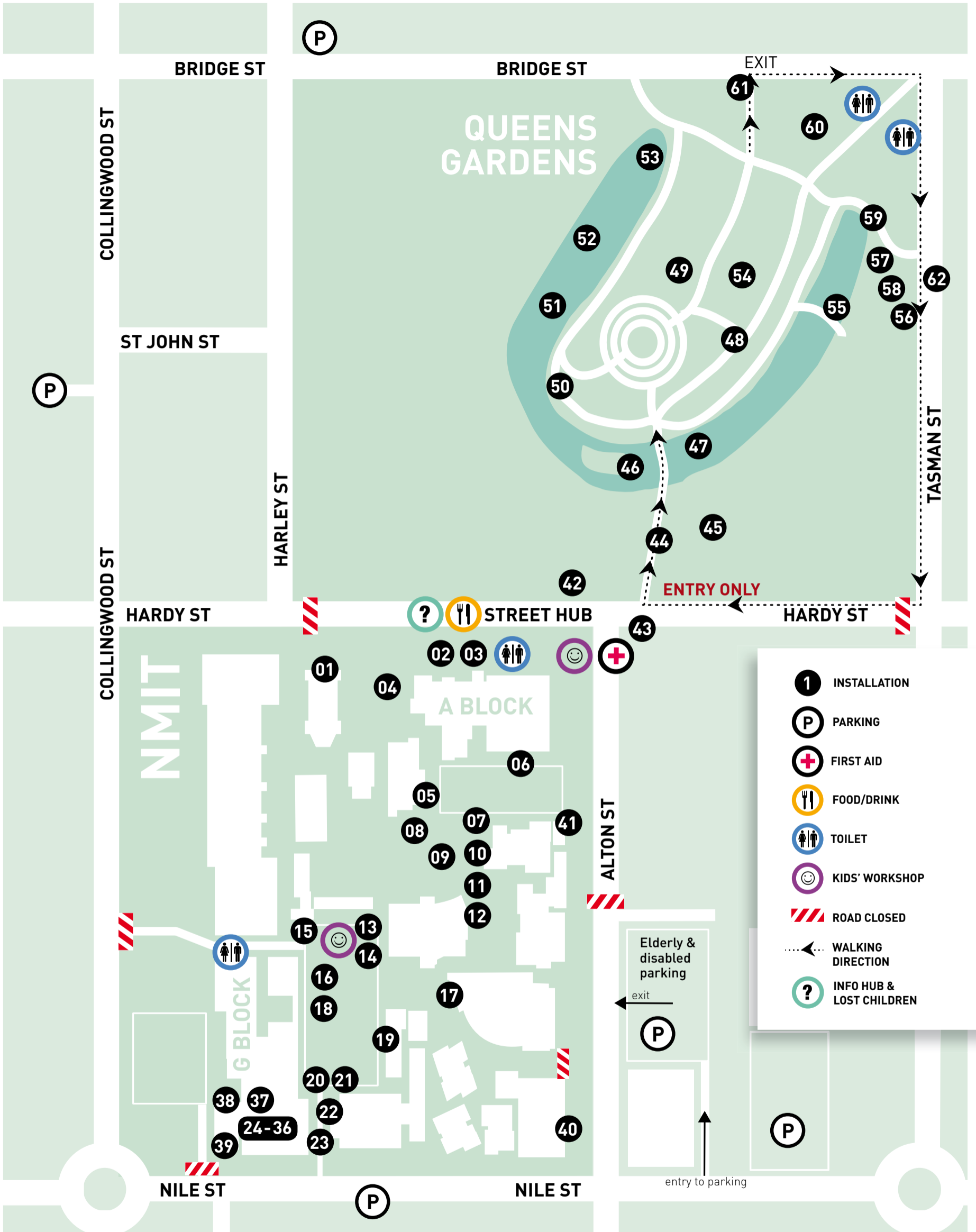

ROUTE

To enhance your safety and enjoyment this year, the route through the Queens Gardens is **ONE WAY**. Enter via Hardy Street main gates,

and walk through to the Bridge and Tasman Street exits. Enter the NMIT area from Hardy Street and exit onto Alton Street.

Late changes may be necessary in an event such as this. The organisers reserve the right to make alterations to this programme.

LIGHT NELSON ARTISTS' TALKS

Light Nelson welcomes internationally renowned digital artist Jon Baxter and production maestros David Goldthorpe & Debbie Fish to talk about their work. A great opportunity to hear more about their Light Nelson installations and other exciting projects. Free and open to all.

JOHN BAXTER

Saturday 9 July, 1 pm

NMIT, Johnny Cash room
Arts & Media building, Nile St.

DAVID GOLDTHORPE & DEBBIE FISH

Sunday 10 July, 1pm

NMIT, Johnny Cash room
Arts & Media building, Nile St.

FINDING LUCINDA FAIRWEATHER



Victorian Nelson's port was haunted by sailing ships, plying local and global waters for the rapidly changing city. Dive into this world with your mobile device, piecing together a mystery that moves fluidly between centuries. Find clues to explore a tale of intrigue through the old city and shifting shoreline around to the port.

More info at flf.geek.nz



NEON

Their retro sound was the sleeper hit of Light Nelson 2014. The men in white suits are back with their electronic band NEON, playing in the stunning space of Old St John's with a mysterious robot and visuals by Klaasz Breukel.

Performances will start at 6.30 pm, 7.30 pm & 8.30 pm every night

Old St John's, Hardy St.

Be early to get a seat!

HARDY STREET HUB

Visit this busy hub to grab a delicious snack from food vendors, meet your friends for a coffee or just hang out. Find the Light Nelson Info Hub for information about the event, assistance, lost property and first aid. This is also where you register for workshops and check out the opportunities for you and your kids to get creative.

SOCIAL MEDIA

We're all about technology and making art accessible to all. We'd love you to share your **#LightNelson** experience...

 [@Light_Nelson](https://twitter.com/Light_Nelson)
 facebook.com/lightnelson
 [@Light.Nelson](https://www.instagram.com/Light.Nelson)

ENJOYING LIGHT NELSON

WEATHER

This is an all-weather event and will be on unless it's not safe to go ahead. If in doubt check our website or Facebook page (details below). Wear sturdy practical footwear and wrap up warmly.

PARKING

We encourage you to bike, walk or car-share. See parking areas on the map overleaf. The NMIT park (cnr Nile and Alton) is reserved for elderly and disabled.

ONE-WAY ROUTE

The route through the Queen's Gardens is one way this year. Enter via Hardy St main gates, and walk through the installations to the Bridge St exit.

KIDS

The event is great for kids, but backpacks are advised for tiny tots, rather than buggies. Please keep an eye on children at all times. There are unfenced waterways, electric cables, fire performance and delicate artworks!

NMIT ROUTE

Enter the NMIT area from Hardy St (next to A Block) and exit onto Alton St.

PHONES AND CAMERAS

You're welcome to take photos to keep or to share on Instagram, Facebook etc.

LIGHTBULB MEN

Look out for our friendly Lightbulb Men – they'll be happy to receive any donations.

INFORMATION OFFICE

Lost children or any other problem? Go to the information office at the Light Nelson Info Hub in Hardy St.

WOW Lightbulb Men courtesy of WOW@ artwork: thisisthem.com

HUGE THANK YOU TO OUR SPONSORS!

Light Nelson wouldn't be possible (or free!) without our supporters. Please support them – they help make Nelson the best place in New Zealand to live! Many thanks to this willing group and also to our Luminaries.

MAJOR SPONSORS



EVENT SPONSORS



SUPPORTERS

Fulton Hogan, The Brook Sanctuary, Trailways, Strawberry Sound, Rockquest Promotions

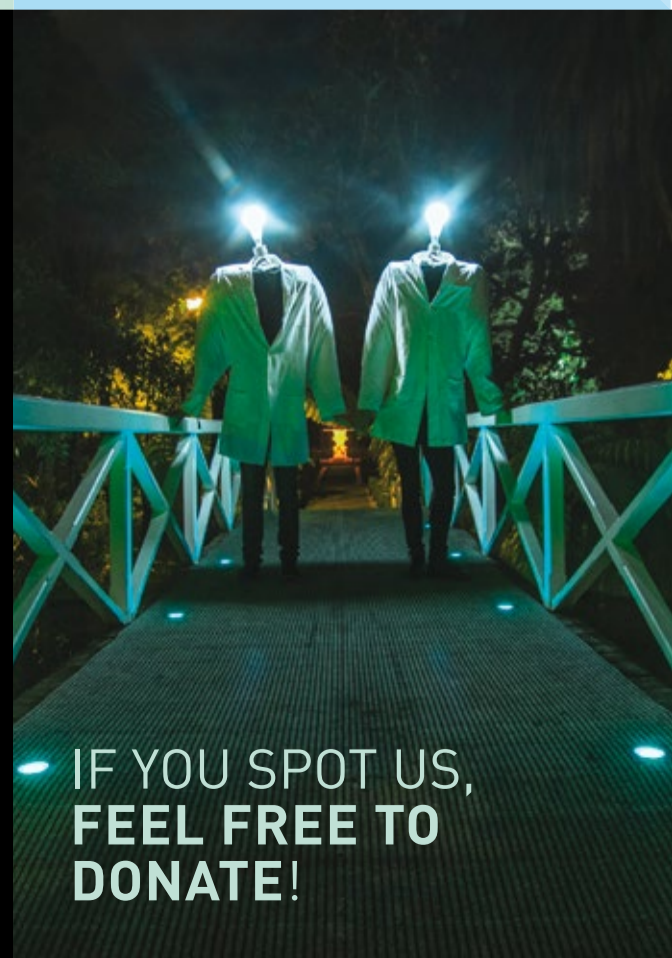

IF YOU SPOT US,
FEEL FREE TO
DONATE!



Trafalgar Centre progress update

With the Nelson Giants' games done for the season, all of the Trafalgar Centre and the surrounding Rutherford Park is a construction site once again.

In the main stadium, the floor is being prepared to be sanded and recoated. This involves punching all the nails to get them below sanding level. Sections of the ceiling in the main stadium are being reinstated and so are the facilities on the first floor of the southern end.

The floor has gone in on the western corridor and on the Northern building, half the floor has been poured and the structural steel needed is currently being manufactured.

Outside the Centre, work is going well in Rutherford Park. The access roads, carparks, and the

plaza area are all in progress and landscaping has already started with some trees and other plants now in the large carpark. Thanks to the students from Auckland Point School who pitched in to help with the planting recently.

The majority of Paru Paru Road is now permanently closed. The road itself, beyond the new entrance to the Trafalgar Centre, is being removed and the whole area west of the Maitai Walkway will be levelled to bring it up to around the same height as the Walkway.

Those who used Paru Paru Road for parking now have access to a new small carpark by the Squash Court. At the moment, this area is still to be sealed but weather has delayed that. When this car park dries sufficiently it will be sealed.

A decision on the best approach for the replacement roof is likely within a few weeks. Council will decide whether to proceed with putting the new roof over the existing roof or replace the current roof cladding.

Remember you can keep an eye on progress using the web cams on the Trafalgar Centre projects page on the Council website, nelson.govt.nz.



School holidays at the Library

School holidays are nearly upon us, so why not check out what's on at a Library near you?! Most activities are free and you can book in any of these sessions by calling 546 0200, or emailing library@ncc.govt.nz



Elma Turner Library		Bookings essential?
Monday 11 July, 1pm	Police dog and puppy in training	-
Monday 11 July, 3pm	Mystery Ink, 4-7 year olds (\$5 cost)	Yes
Tuesday 12 July, 11am	Simply Stories	-
Tuesday 12 July, 2pm	Introduction to computer coding	Yes
Wednesday 13 July	Welcome to Tahunanui Community Centre	-
Thursday 14 July, 11am	Performance of Thumbelina	-
Thursday 14 July, 2pm	Origami with Piri and Ken	Yes
Friday 15 July, 11am	Simply Stories	-
Friday 15 July, 3pm	Mystery Ink, 8-11 year olds (\$5 cost)	Yes
Monday 18 July, 11am	Simply Stories	-
Monday 18 July, 2pm	Learn morse code and more	Yes
Tuesday 19 July, 11am	Simply Stories	-
Tuesday 19 July, 2pm	Craft your own hidden book	Yes
Wednesday 20 July, 11am	Mystery Morning with Bridget	Yes
Wednesday 20 July, 1pm	Learn to play ukulele	Yes
Wednesday 20 July, 3pm	Mystery Ink, 4-7 year olds (\$5 cost)	Yes
Thursday 21 July, 11am	Simply Stories - Librarians choice	-
Thursday 21 July, 2pm	Make your own shadow puppets	Yes
Friday 22 July, 11am	Simply Stories	-
Friday 22 July, 3pm	Mystery Ink, 8-11 year olds (\$5 cost)	Yes
Stoke Library		Bookings essential?
Tuesday 12 July, 1pm	Learn morse code	Yes
Friday 15 July, 11am	Simply Stories	-
Tuesday 19 July, 1pm	Craft your own hidden book	Yes
Friday 22 July, 2pm	Make your own shadow puppets	Yes



MEETINGS

The following meetings of the Nelson City Council have been scheduled:

Regional Pest Management Joint Committee - Tasman District Council Chamber, 189 Queen Street, Richmond	9.30am	29 June
Community Investment Funding Panel - Library Activity Room, Elma Turner Library	12pm	29 June
Planning and Regulatory Committee	9am	30 June
Extraordinary Council Meeting	10am	30 June
Regional Transport Committee	2pm	4 July
Community Services Committee	9am	7 July
Hearings Panel - Other At conclusion of Community Services Committee		7 July
Governance Committee	9am	14 July
Chief Executive Employment Committee - Ruma Ana	9am	15 July

Other Meetings

Nelson Youth Council	1pm	8 July
----------------------	-----	--------

Notes:

1. Unless otherwise shown, the meetings will be held in the Council Chamber, Civic House, Trafalgar Street, Nelson.
2. A public forum is held during the initial period of the Committee/Council meeting. Anyone wishing to speak at this public forum is asked to give prior advice to an Administration Adviser on 546 0200.
3. Agendas will be available for perusal at the Customer Service Centre in Civic House, or at Nelson Public Libraries, two days prior to the meeting.
4. Agendas and minutes for Council meetings can be viewed on Council's website nelson.govt.nz.

Contributions updated

Development and Financial Contributions updated for inflation for 2016/17 are available on Council's website, nelson.govt.nz (search phrase = contributions). These updated contributions will apply from 1 July 2016.

nelson.govt.nz Search = contributions

Great white butterfly programme success

The Department of Conservation's (DOC) great white butterfly eradication team finished its property searches in early June and scientific analysis of data is now taking place to establish if the pest butterfly has been successfully eradicated.

The result of the analysis should be known in a few months.

DOC Great White Butterfly Project Manager Michael Shepherd said the eradication team's intensive searching of gardens and the willing assistance of the public appears to have paid off, with no great white butterfly detections since December 2014.

"The Department of Conservation gives a

massive thank you to the people of Nelson Tasman for the support we've been given for the great white butterfly eradication programme."

One of the more memorable parts of the eradication programme was the \$10 bounty for dead great white butterflies offered during the spring school holidays in 2013. School children keenly joined the butterfly hunt, netting in total 134 great white butterflies.



Community Investment Funding Panel representative voting now open

Council would like to invite the community to vote for their preferred community representative to join the existing Community Investment Funding Panel, currently comprising of three other community members and chaired by the Council's Group Manager, Community Services.

This position is voluntary and for individual representation (not on behalf of a community

organisation). The position involves attending approximately 4 meetings a year, for a total of around 16 volunteer hours a year.

The role primarily includes reviewing applications for Community Investment Funding and allocating appropriate levels of funding

in consensus with the Community Investment Funding Panel.

To vote for your preferred candidate go to nelson.govt.nz (search = community investment funding).

Voting is now open and closes 18 July.

nelson.govt.nz

Search = community investment funding

Mayor's Message and Councillor's Comment

With the local elections coming up later in the year, the Mayor's Message and Councillor's Comment will be taking a break until after election day.

Want to know more about this year's local elections, including enrolling to vote? Head to nelson.govt.nz (search phrase = elections 2016). This year's election voting period starts on Friday 16 September 2016. Election day is Saturday 8 October

2016 and voting closes at midday on that day. Make sure you're enrolled to vote to have your say.

nelson.govt.nz

Search = elections 2016

What's on in Nelson?

Do you know where to find out what's on in Nelson? Head to Itson.co.nz. It'sOn is a free service provided by the Nelson City Council that offers an online calendar of events to the public. There are so many events taking place and planned in this vibrant city, now you don't have to miss out on anything!

What's on – at a Council venue near you

Stoke Memorial Hall

Celtic Pipe Band's Fundraising Ceilidh: 2 July, 7–11pm

Queen's Gardens/Albion Square

Light Nelson: 8–12 July, 5.30–9.30pm

Nelson Public Libraries

Elma Turner Library

CSI: Elma Turner:

- The Case of the Jinxed Journal – Murder mystery with clues appearing in the Library and via social media: 25 June–12 July
- Come and meet Senior Constable Mick Moorhouse and his Police Dogs, Wes and Tala: 11 July, 1pm
- Alan Carter talks about being The Accidental Crime Writer: Tue 12 July, 1pm
- Hear how Neil Kitchen, a Detective at the Nelson Criminal Investigation Branch,

goes about solving crime: 13 July, 1pm

- Murder in the Library – hosting three talented New Zealand crime writers, including Auckland author Ben Sanders and local authors Alan Carter and Mike Ponder: 14 July, 6.15pm
- Tips to Protect Yourself Against Crime with Karen Clark from Neighbourhood Support: 15 July, 1pm
- The Mad, the Bad and the Bawdy – Real Crime in Nelson with Jessie Bray Sharpin: 17 July, 2pm

Children's events:

- Mystery Ink Science – forensic sessions for kids – \$5 per child, book early, limited spaces. Mon 11, Fri 15, Wed 20, Fri 22 July, 3–4pm
 - Excerpts from Thumbelina performed by Live Arts Nelson – Hunt for the flowers and win a family pass: 14 July, 11am
- Small Time at the Children's Library – Stories and songs for under 2yr olds: Wednesdays,

10.30am, during term time only

Story Time at the Children's Library – Stories and songs for over 2yr olds: Thursdays, 2pm, during term time only

BookChat: 10.30am the second Tuesday of each month

STEMwriters: Second Tuesday of each month, 2pm

Stoke Library

BookChat: 5.30pm the third Wednesday of each month

Small Time – Stories and songs for under 2yr olds: Tuesdays, 10.30am, during term time only

Story Time – Stories and songs for over 2yr olds: Wednesdays, 10.30am, during term time only

Nightingale Library Memorial

Science Stars – World of Bubbles workshop: 12 July, Sensory Play (2–4yrs)

9.30–10.15am, Discovery Lab (4–7yrs)
10.30–11.30am, Discovery Lab (4–7 yrs)
11.45am–12.45pm

Museums and Galleries

Nelson Provincial Museum

Weekdays, 10–5pm; weekends and public holidays, 10–4.30pm

Vital Statistics: Until 30 June

The Suter on Halifax Street

Gallery open 9.30am–4.30pm 7 days

The Suter Te Aratoi O Whakatu – Philip Trusttium BOO: Until 3 July

Refinery ArtSpace

Weekdays, 10am–5pm; Saturdays, 11am–2pm

From Hare to Eccentricity – new quirks by Lloyd Harwood: Until 1 July

nelson **its on**
www.itson.co.nz



CHECK OUT

Light Nelson 2016, 8–12 July

Light Nelson is set to brighten up the winter with an outdoor gallery of brilliant light installations, clustered around the lily pond and massive trees of the city's historic Queens Gardens, Albion Square, and into the NMIT campus. In a collaboration of art, science and technology, over 60 artists let their creativity loose through a range of innovative media including laser technology, digital imagery, performance and music with high levels of interaction and surprise for the viewer. It's an irresistible mix: a garden walk in the clear dark night of winter with magic moments of illusion, beauty, interaction and fun. Free admission!